

Santa Fe Springs Restoration Focus Area

# Drinking Water Nitrate Alert Gilchrist and Alachua Counties



Howard T. Odum  
**FLORIDA  
SPRINGS  
INSTITUTE**

Prepared by Dr. Robert L. Knight  
Director Florida Springs Institute

# SYNOPSIS

- FDEP is conducting a site-specific study of the Santa Fe Springs Restoration Focus Area
- Two years (8 quarters) of ground and surface water sampling are complete
- Nitrate nitrogen levels are elevated in all 20 monitoring wells and in all Santa Fe River springs
- Four wells have consistent nitrate concentrations above the state and federal drinking water standard



# Florida Department of Environmental Protection

## Division of Environmental Assessment and Restoration

# Nitrate in Ground Water, Springs, and River Water in the Santa Fe Springs Restoration Focus Area

Santa Fe River Springs Protection Forum  
July 24, 2015



FDACS OAWP



Presented by Brian Katz, FDEP

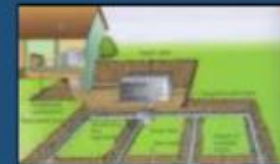



Santa Fe Springs Restoration Focus Area  
Monitoring Well #12 and Surrounding  
Landuse

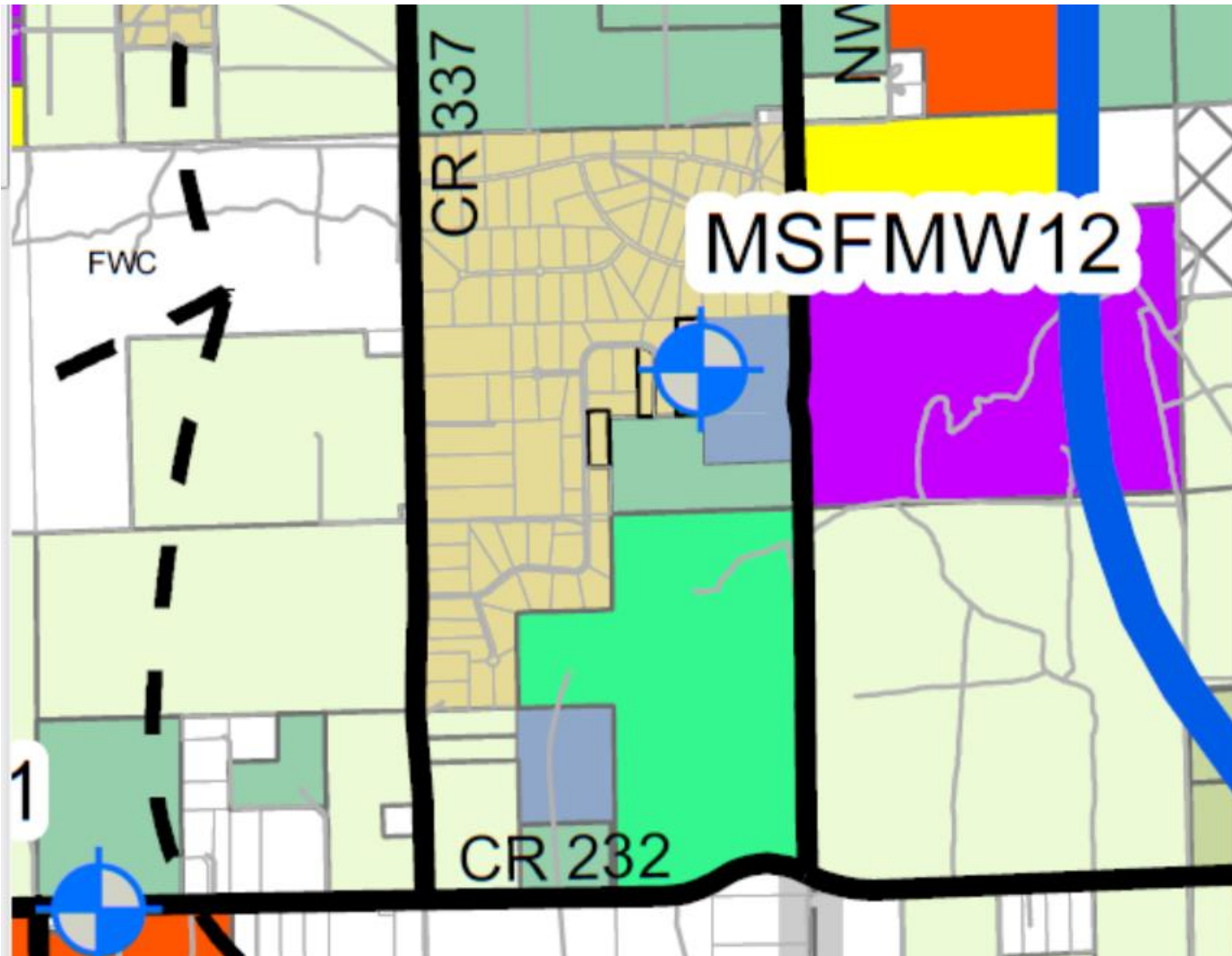

# Santa Fe Springs Restoration Focus Area

## Land Use legend

### Legend

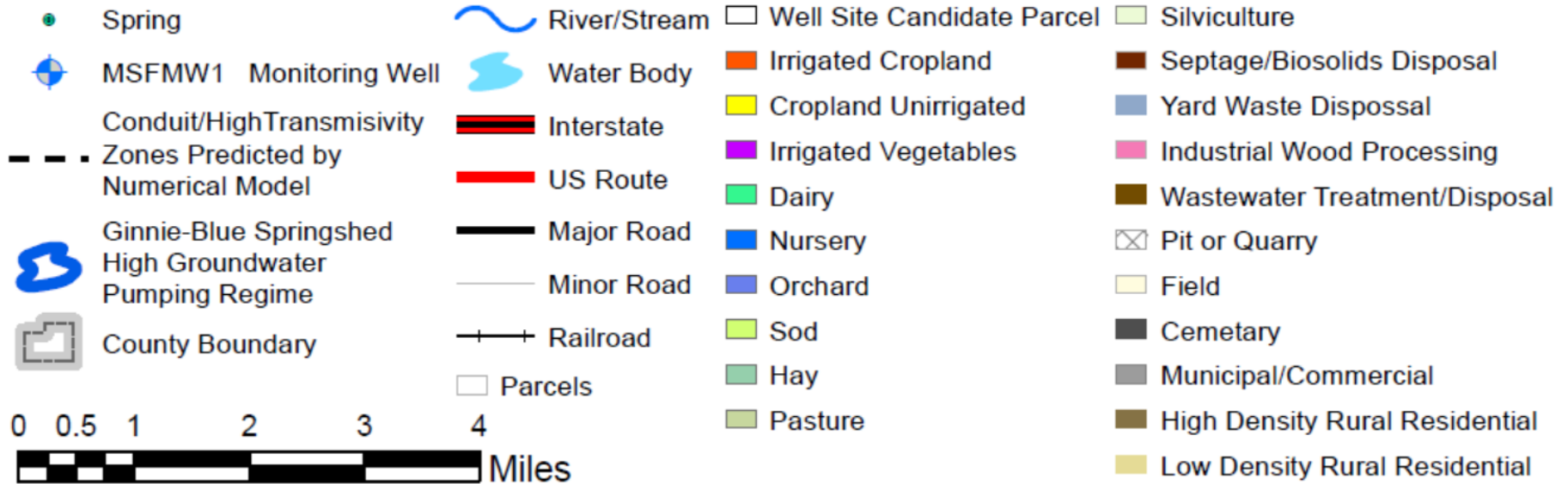

### CURRENT LAND USE WITH MONITORING WELL LOCATIONS



# Santa Fe Springs Restoration Focus Area

## Monitoring Well #7 and Surrounding Landuse

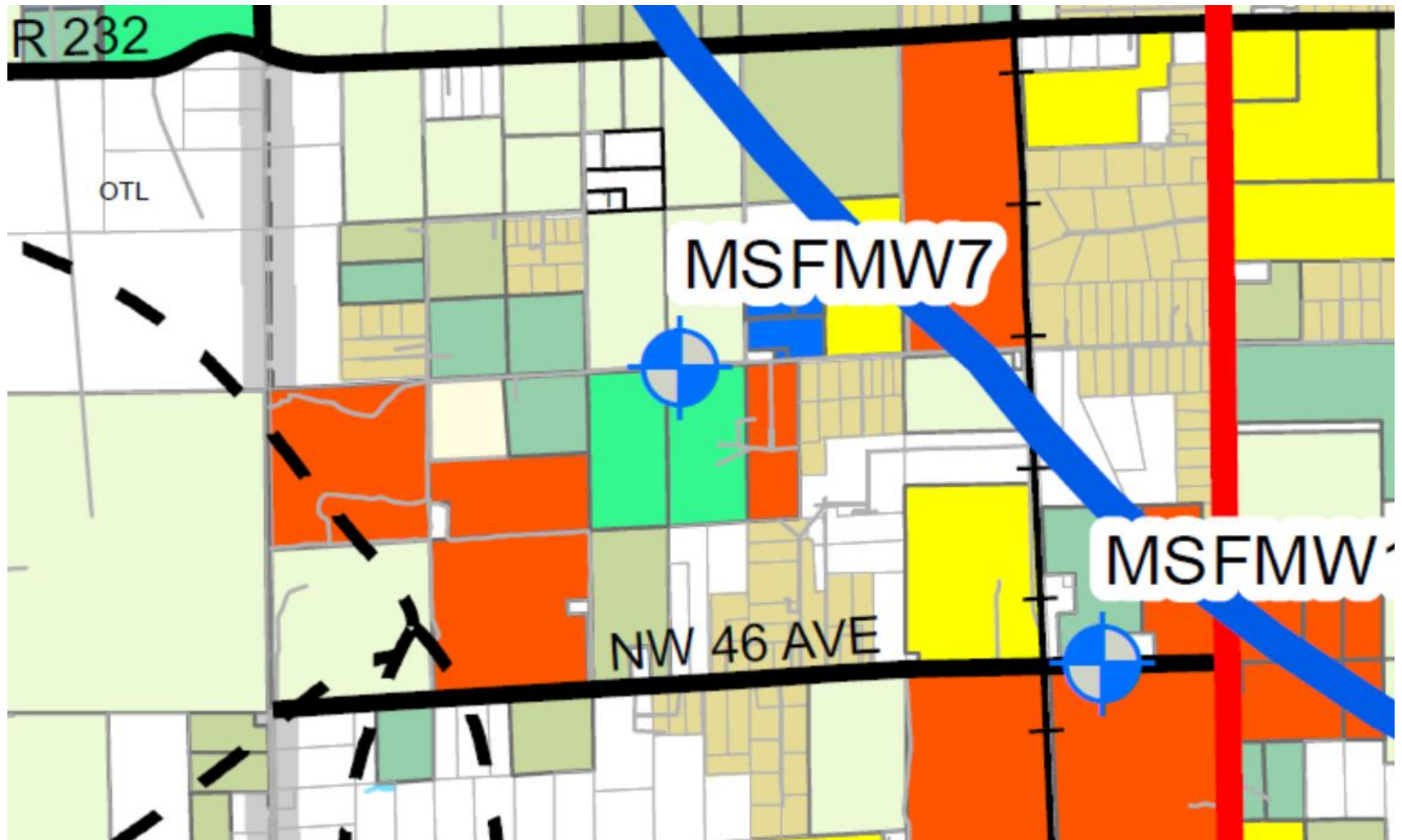



# Santa Fe Springs Restoration Focus Area

## Potentiometric Surface and Groundwater Flow Directions

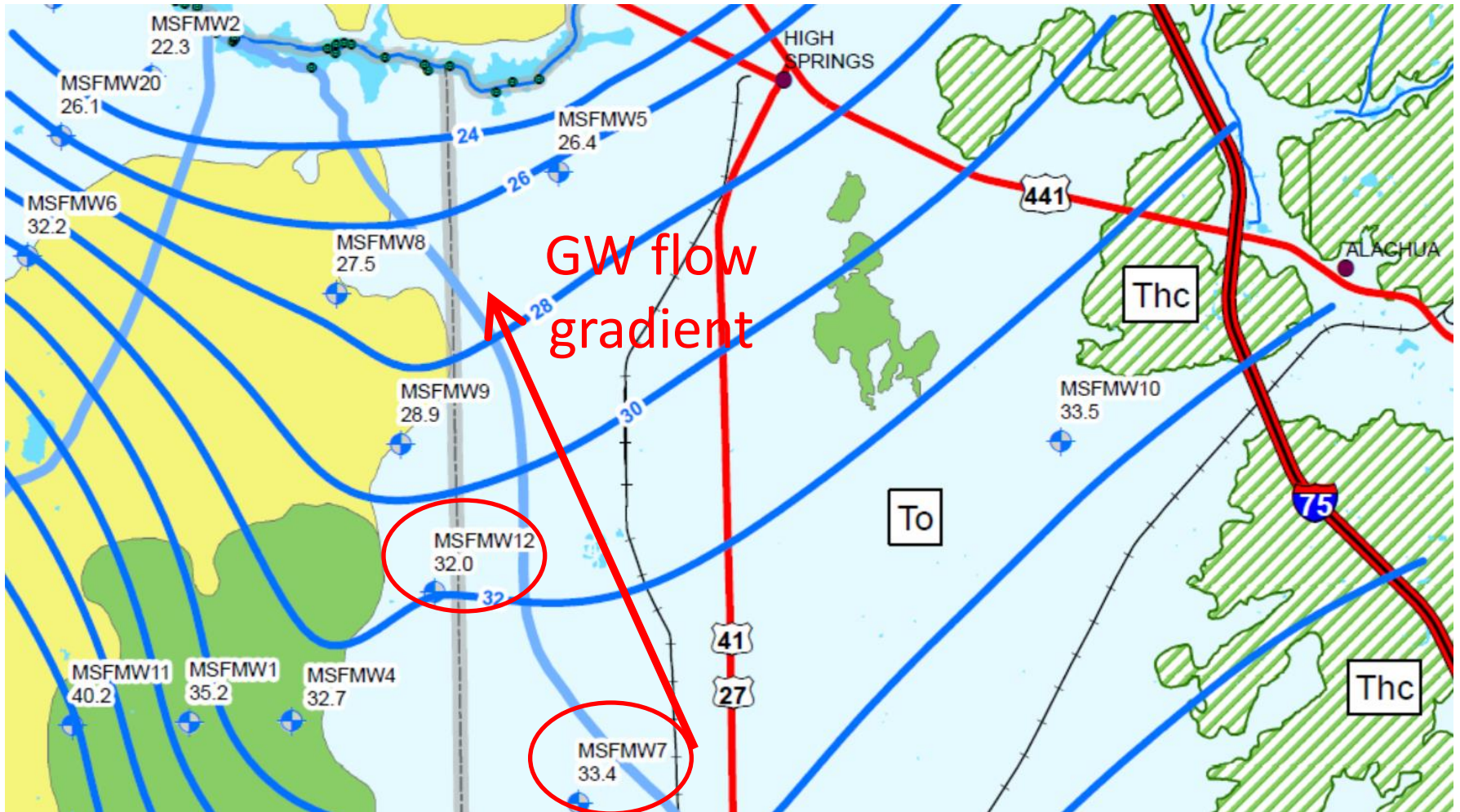

# SUMMARY

- Nitrate levels in two wells downgradient from dairies are consistently higher than the drinking water standard
- There are dozens of private wells in these areas
- The Department of Health, FDEP, and county public health agencies are urged to issue a drinking water advisory for all residents and to take immediate steps to correct this situation